

OVERVIEW OF FARMINGTON CANAL GREENWAY

Farmington Canal Greenway, Phase IV - Hillhouse Avenue to Long Wharf Drive - New Haven Connecticut

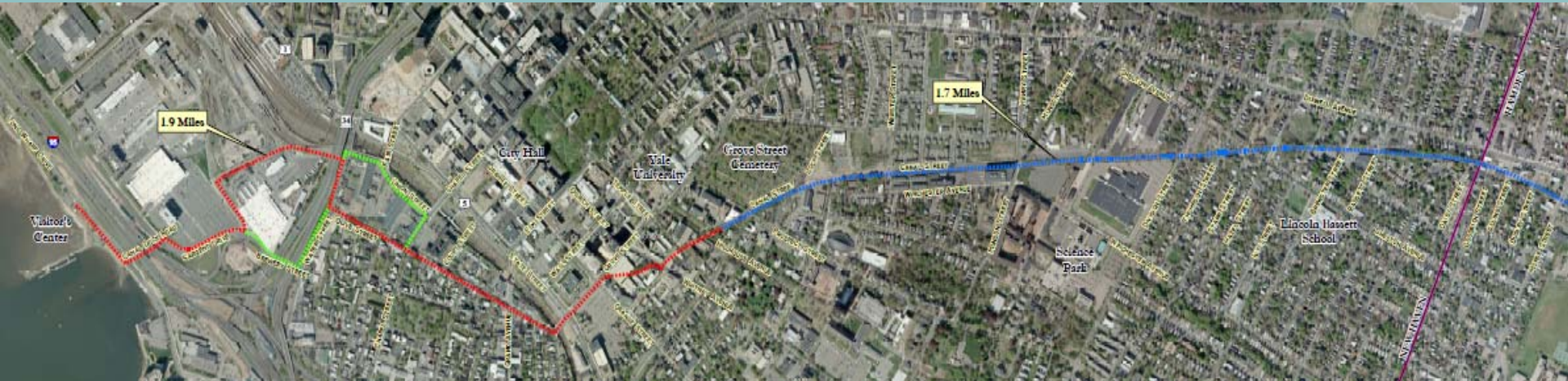

Legend



Completed (Phase I, II, & III)



Under Design (Phase IV)



Alternate Route



PHASE 4

Farmington Canal Greenway, Phase IV - Hillhouse Avenue to Long Wharf Drive - New Haven Connecticut

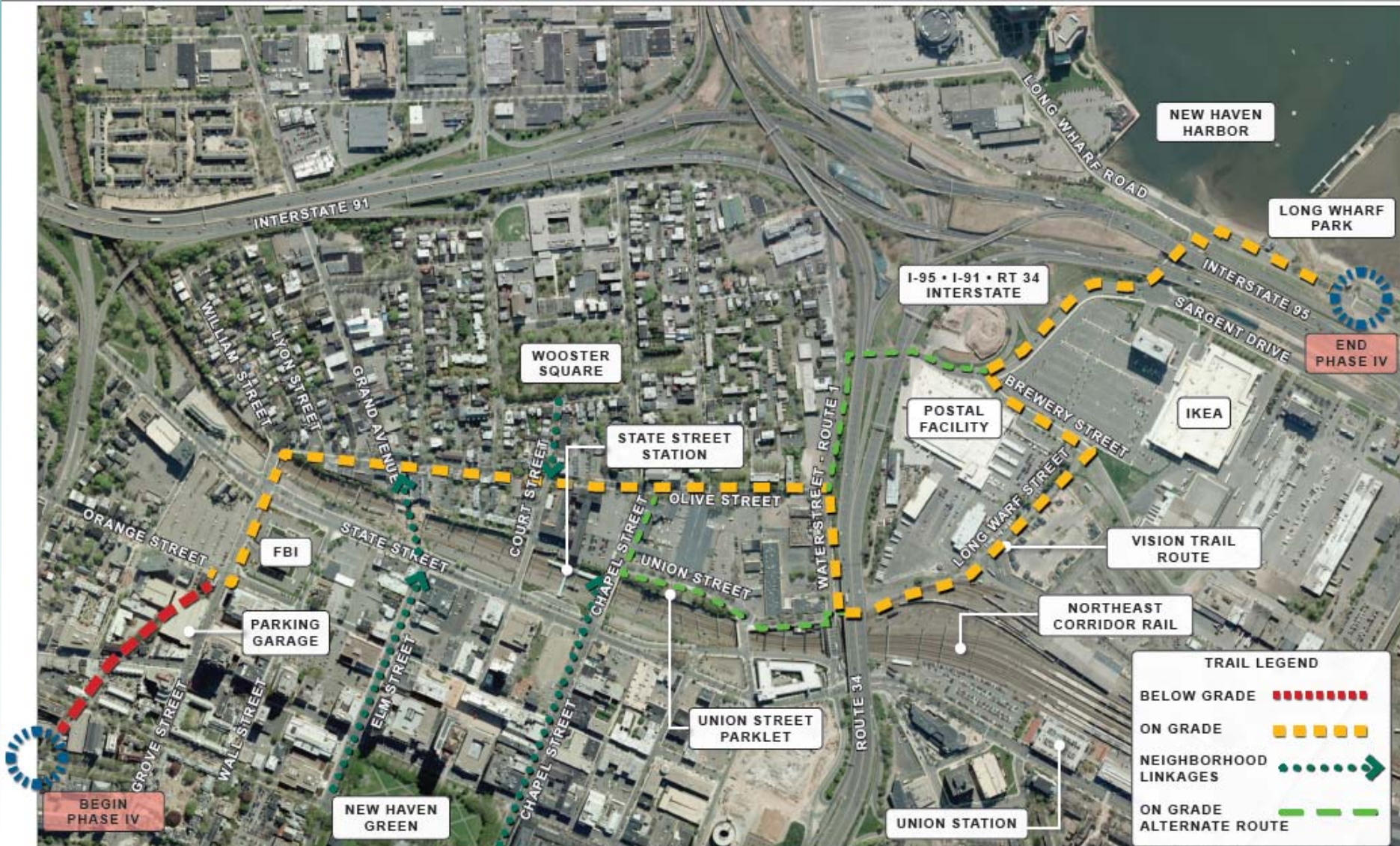

DEFINITIONS OF TERMS

Farmington Canal Greenway, Phase IV – Hillhouse Avenue to Long Wharf Drive – New Haven Connecticut

Below Grade Trail: Greenway from Hillhouse Ave South to Grove Street

At Grade Trail: Greenway from Grove Street South to Long Wharf Drive

Bike Lane: 5' wide painted lane on street exclusively for bicycle use. The bike lane is located on the right hand side of the street. Cyclists ride with the direction of traffic and are expected to cross traffic lanes to make left turns.

Sharrow Lane: A vehicle lane with sharrow symbols painted approximately 200' apart. The lane is shared between vehicle and bicycle traffic. Sharrow lanes are currently being experimented with around the country. They are not currently recognized by the Federal Highway Administration in the Manual on Uniform Traffic Control Devices (MUTCD).

Bike Box: A painted area reserved for bicyclists in front of the vehicle stop bar. The purpose of the bike box is to allow for cyclists to queue in front of traffic stopped at a traffic signal.

Approach Lane: A painted bicycle lane provided between two lanes of traffic instead of to the right. This allows for bicycles to enter the intersection in a position to make a left hand turn.



Bike Lane Exclusively for bicycle use



Bike box allowing cyclists to queue at a traffic signal



Sharrow Lane

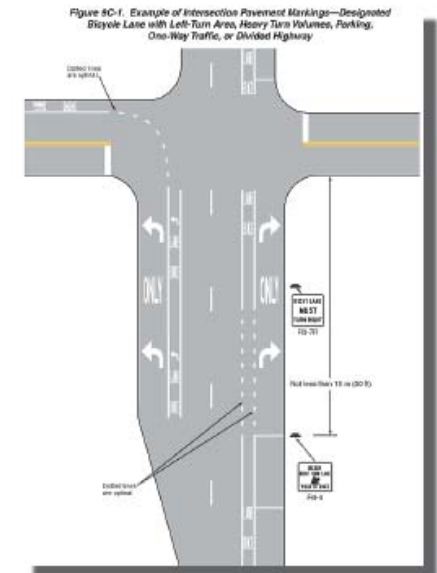

Approach Lane



FARMINGTON CANAL IMAGES

Farmington Canal Greenway, Phase IV - Hillhouse Avenue to Long Wharf Drive - New Haven Connecticut

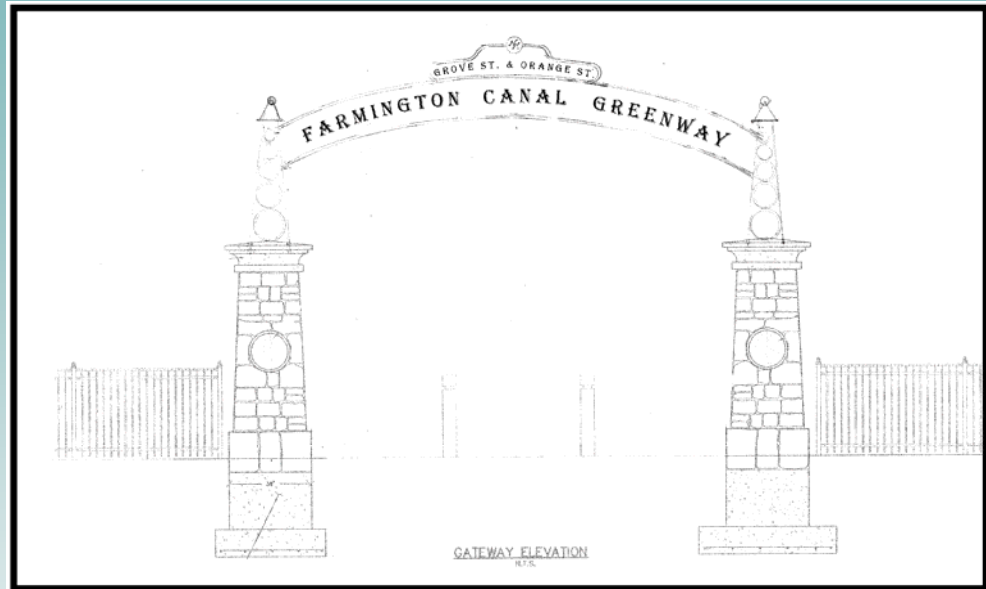
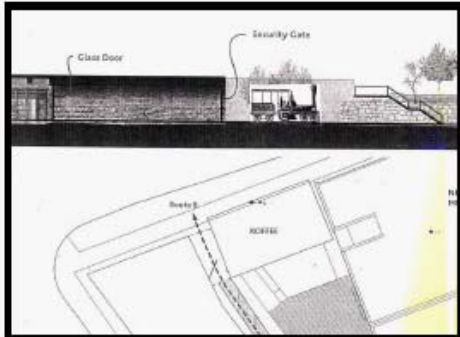
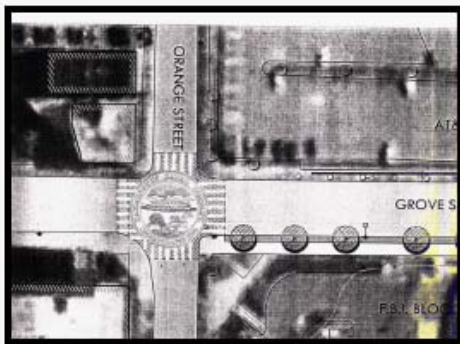

EXISTING CONDITIONS - BELOW GRADE

Farmington Canal Greenway, Phase IV - Hillhouse Avenue to Long Wharf Drive - New Haven Connecticut



BELOW GRADE - PREFERRED ALTERNATIVE

Farmington Canal Greenway, Phase IV - Hillhouse Avenue to Long Wharf Drive - New Haven Connecticut



LONGITUDINAL SECTION:
SCALE: 1" = 40'-0"

SELECTED DESIGN

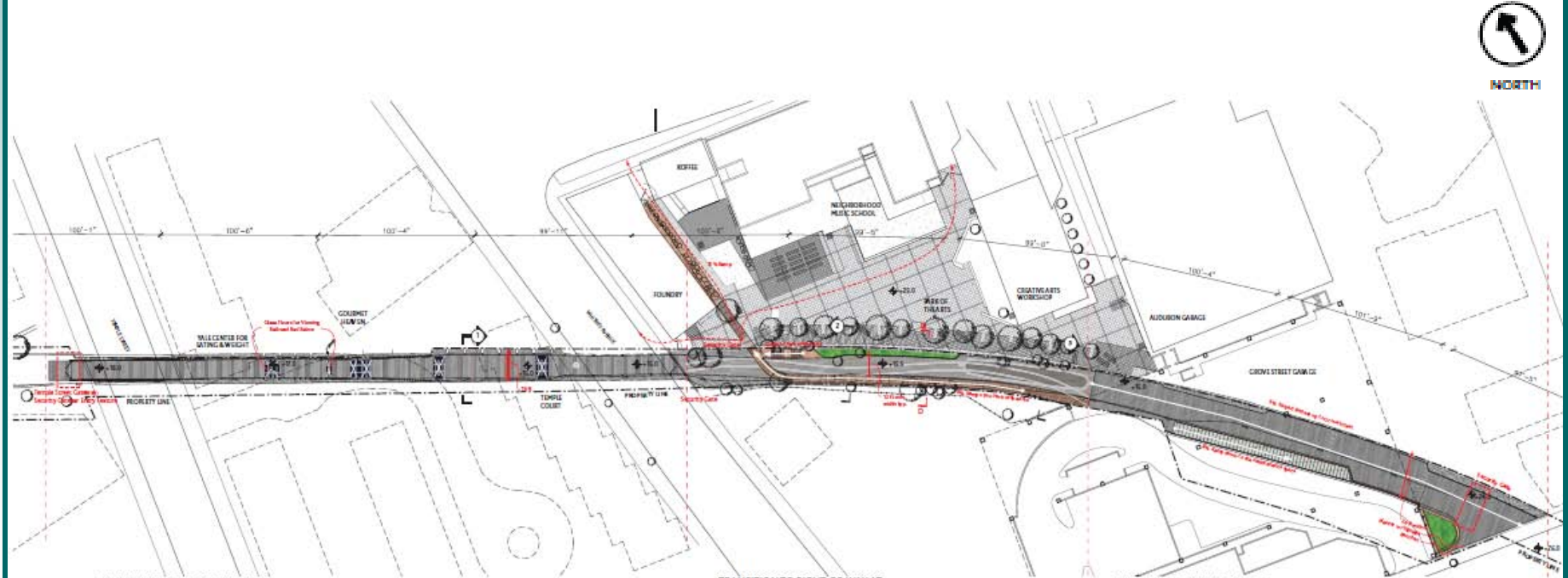

TUNNEL AND INTERPRETIVE CENTER
UNDER TEMPLE COURT

TRANSITION TO RIGHT-OF-WAY AT
WHITNEY AVENUE AND PARK OF THE ARTS

RAMP UNDER PARKING GARAGE
UP TO GROVE STREET

SITE PLAN:
SCALE: 1" = 40'-0"



BELOW GRADE - PREFERRED ALTERNATIVE

Farmington Canal Greenway, Phase IV - Hillhouse Avenue to Long Wharf Drive - New Haven Connecticut

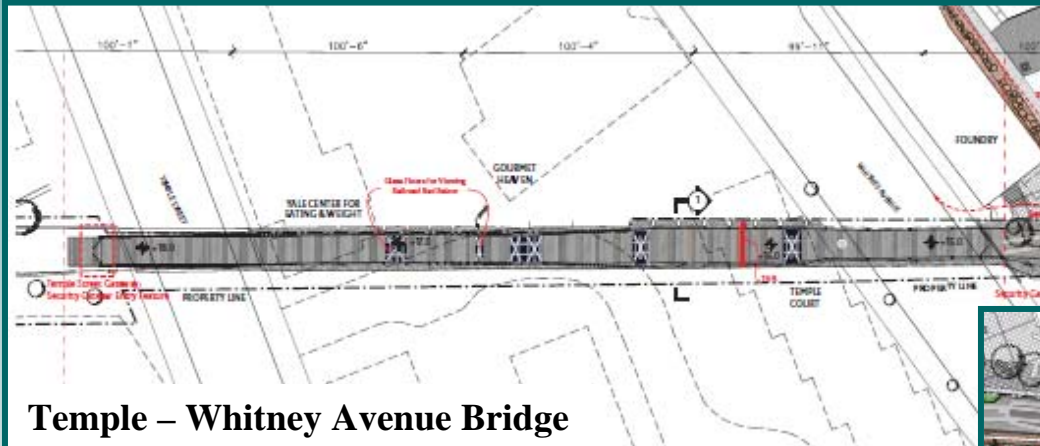

Temple - Whitney Avenue Bridge

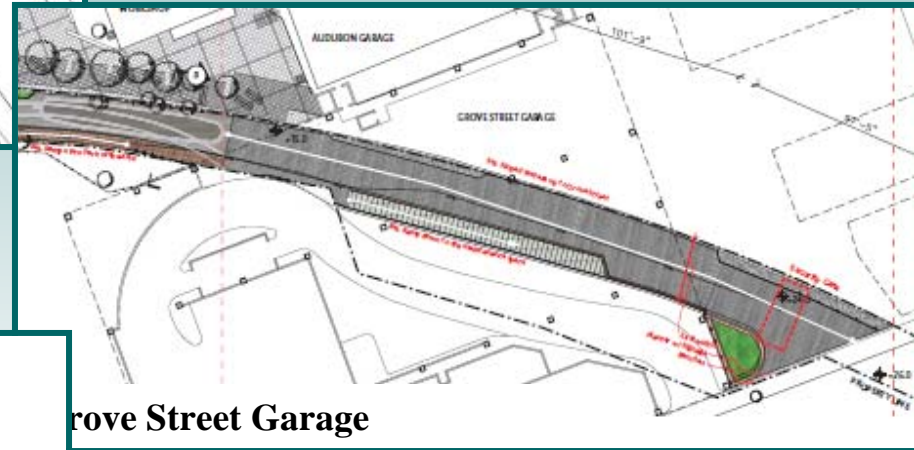

Grove Street Garage

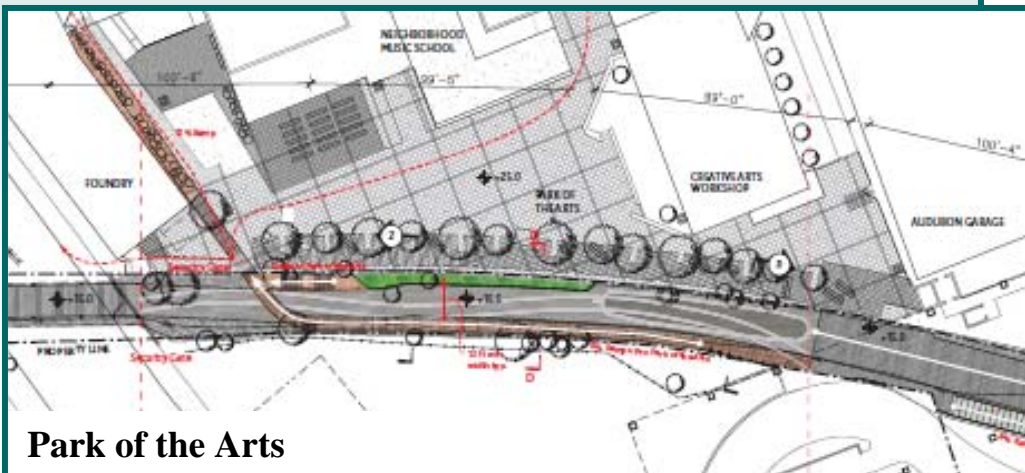

Park of the Arts



BELOW GRADE - PREFERRED ALTERNATIVE

Farmington Canal Greenway, Phase IV - Hillhouse Avenue to Long Wharf Drive - New Haven Connecticut



VIEW TOWARDS WHITNEY AVENUE



EXISTING CONDITIONS - OLIVE STREET

Farmington Canal Greenway, Phase IV - Hillhouse Avenue to Long Wharf Drive - New Haven Connecticut



EXISTING CONDITIONS - VISION TRAIL

Farmington Canal Greenway, Phase IV - Hillhouse Avenue to Long Wharf Drive - New Haven Connecticut



EXISTING CONDITIONS - LONG WHARF DRIVE







Farmington Canal Greenway, Phase IV - Hillhouse Avenue to Long Wharf Drive - New Haven Connecticut



PREFERRED ROUTE

Farmington Canal Greenway, Phase IV - Hillhouse Avenue to Long Wharf Drive - New Haven Connecticut

LEGEND

- SHARROW ROUTE 
- ALTERNATE SHARROW ROUTE 
- PATTERNED CROSSWALKS 
- TREES 
- CONCRETE WALK 
- CONCRETE WALK 

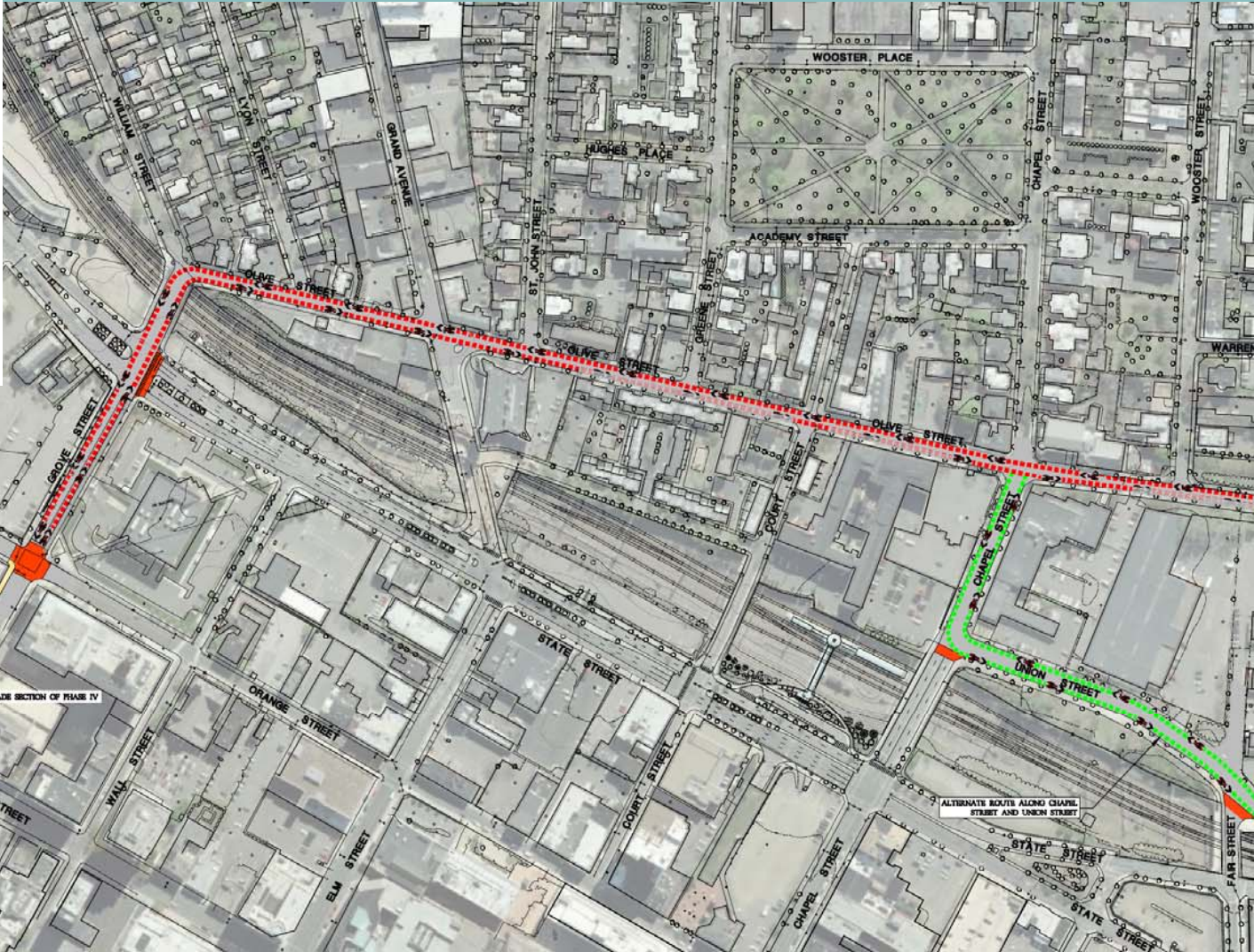



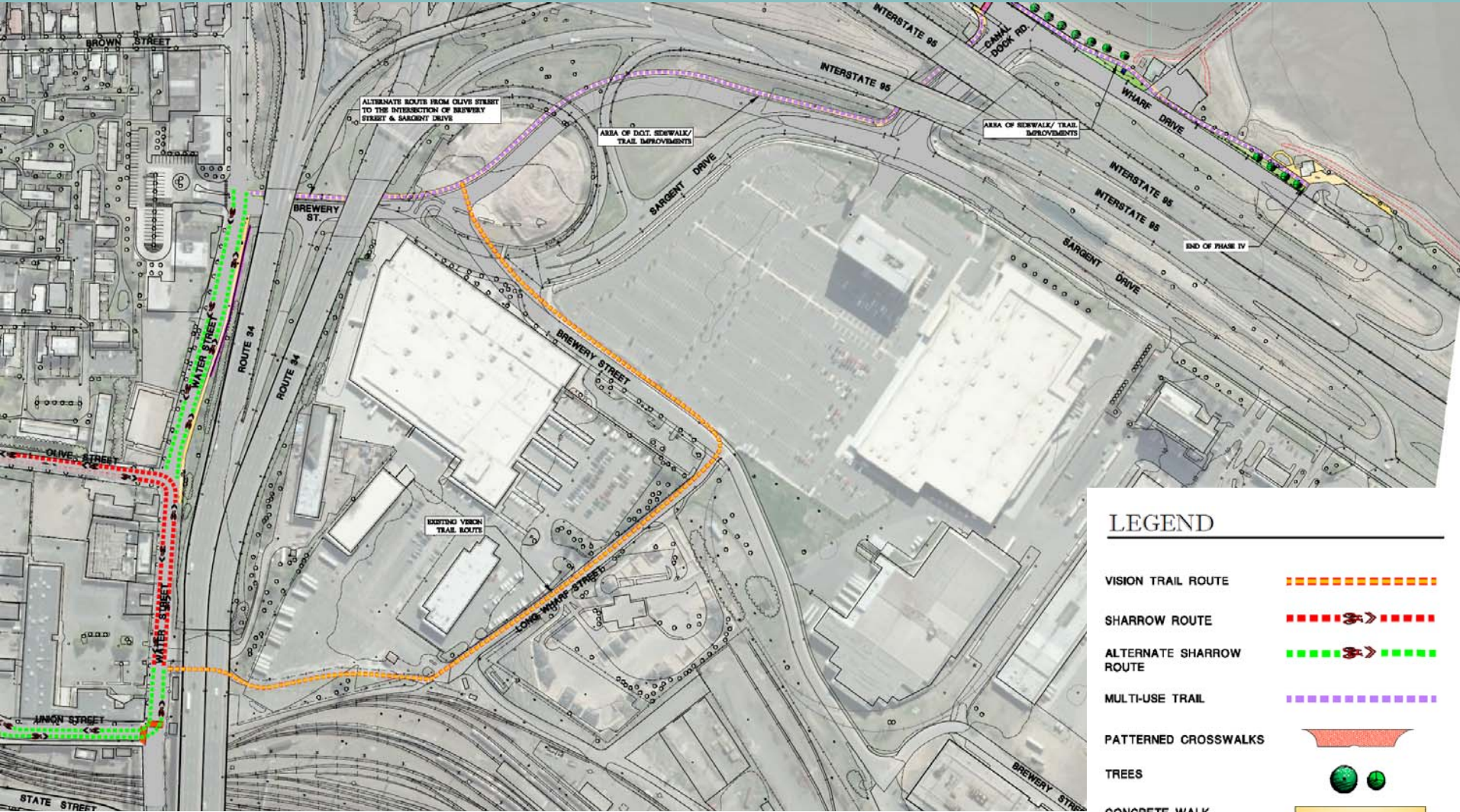

PREFERRED ROUTE

Farmington Canal Greenway, Phase IV - Hillhouse Avenue to Long Wharf Drive - New Haven Connecticut



LEGEND

- VISION TRAIL ROUTE 
- SHARROW ROUTE 
- ALTERNATE SHARROW ROUTE 
- MULTI-USE TRAIL 
- PATTERNED CROSSWALKS 
- TREES 
- CONCRETE WALK 