

Beaver Hills

Including Edgewood

Beaver Hills

People to know

Including Edgewood

Get to know your Alder! The City of New Haven is divided into 30 wards, each with their own Alder. Every two years, an Alder is elected to represent each neighborhood in the municipal government.

Send your Alder an email with questions or to ask to be put on their email list. Each Alder sends out periodic emails about events going on in the neighborhood.

The Board of Alder meets the first and third Monday of every month in the aldermanic chambers, 165 Church Street, second floor, except for holidays. During the summer, the Board of Aldermen meets the first Monday of the month. Check out a meeting!

Your Alders



**WARD 28-D
Claudette Robinson
Ward28@newhavenct.net
319 Norton Street
(203) 605-0293**



**WARD 29-D
Brian Wingate
Ward29@newhavenct.net
1500 Ella T. Grasso Blvd.
(203) 401-9457**



**WARD 24-D
Evette Hamilton
Ward24@newhavenct.net
327 Edgewood Avenue
(203) 508-5426**

Beaver Hills

Including Edgewood

People to know

New Haven is divided into 10 Police Districts. **Police District Managers** oversee the officers in each district to ensure the safety of the neighborhood. Police District Managers serve as the links between the Police Chief's Office and the rest of the community.

Your District Manager

Sgt. Max Joyner
mjoyner@newhavenct.net
Work Number: (203) 946-7065

Neighborhood specialists from the Livable City Initiative are committed to the needs of residents of the sections of New Haven they are assigned to. Report major neighborhood problems or issues to your neighborhood specialist.

Your Neighborhood Specialist

Nick Licata
nlicata@newhavenct.net
Work Number: (203) 946-5072
Cell Number: (203) 410-5072

Management Team Chairs head each District's Management Team. Management Teams are organized in each of New Haven's ten community policing districts.

Your Management Team Chair

Evelyn Streater-Frizzle
evelynstreater@gmail.com
Work Number: (203) 530-9643

Beaver Hills

Getting involved

Including Edgewood

A **Management Team** consists of residents within the district who have organized to serve as forum for problem solving and information exchange centering around neighborhood issues. Community Management Teams help residents have a voice in neighborhood improvement and revitalization efforts and are an important link to the police and to other city and social service agencies.

Anyone with an interest in the safety and quality of life in their Community Policing District should attend!



Beaver Hills Historic District

Get involved in your Local Block Watch

Contact Sergeant Max Joyner
(203) 946-7065

Get involved in your Management Team

Beaver Hill Community Management Team
Meets: Every 3rd Tuesday of the month
at 7:00 p.m
Location: Beaver Hill Substation

Beaver Hills

Frequently Asked Questions

Including Edgewood

Where is your fire station?

Westville Fire Station
105 Fountain Street

Where is your police station?

Beaver Hill Substation
386 Whalley Avenue,
New Haven, CT
Phone: 203-946-7065

When does my trash get picked up?

Enter your address here to see the day your trash is picked up:
<http://cityofnewhaven.com/Lookup/>

When are street sweeps?

For information about street sweeps (what they are, when they happen in your neighborhood, and people to contact):

<http://www.cityofnewhaven.com/PublicWorks/sweep/>

Who do you call when...

You smell gas, suspect a gas leak or carbon monoxide
911

You want to shut off your gas or restore your gas
The Southern Connecticut Gas Company
1-800-513-8898

You see a fallen wire
911

You want to report a power outage
United Illuminating Company
203-499-3333

You need food or emergency shelter
Dial 2-1-1

You see an animal that looks sick or is behaving suspiciously or abnormally
Animal control
203-946-8110

You think you may have had physical contact with a sick animal
Health Department
203-946-8174

You have discolored or foul tasting water or need the water turned off
Regional Water Authority
203-624-6671
203-562-4020

You are in an emergency during a storm
(203) 946-8221

Basic information for you and your family to be prepared for any emergency.

<http://www.fema.gov/plan/index.shtm>

Beaver Hills

Resources

Including Edgewood

**Carmel Street
Community Garden**
20 Carmel Street

Lead Coordinator:
Henrietta Hamlet



Photo by Carmel Street Garden



Photo by Carmel Street Garden

**For maps and more information:
<http://www.newhavenlandtrust.org>**

Beaver Hills *Resources continued*

Including Edgewood



Edgewood Park Farmer's Market

At corner of Whalley and West Rock
Avenues

Sundays from 10-2pm
May 5 – December 22

For more information:

<http://cityseed.org/edgewood-park>



Upon this Rock Ministries Pantry

508 Whalley Avenue
(203) 387-1215
Sa (3rd): 9:00A-12:00P

Beaver Hills

Resources continued

Including Edgewood

Non-Profits

Greater New Haven NAACP

545 Whalley Ave, New Haven, CT

naacpnewhaven.org

Higher Heights Youth Empowerment Programs, Inc

419 Whalley Ave #404, New
Haven, CT

(203) 859-6647 –

higherheightyouth.com

Jewish Historical Society

270 Fitch St, New Haven, CT

(203) 392-6125 · jhsgnh.org



Higher Heights Youth Empowerment Programs, Inc.

Beaver Hills *Parks*

Including Edgewood

Beaver Ponds Park

This facility features Bowen Field, a football field, track, and stadium, and a regulation baseball field. The park also includes lagoons and trails in its nature areas.

For more information about these specific attractions check out the Park's website here:

<http://www.cityofnewhaven.com/Parks/ParksInformation/beaverpark.asp>

To find out more about activities at Beaver Ponds Park, please contact the Parks Department for the City of New Haven: 946-8027



Bowen Field Baseball Diamond

Location:

Beaver Ponds Park
Between Sherman Parkway & Crescent
Street, New Haven

Beaver Hills *Parks*

Including Edgewood

In addition to formal programs and events, many park users get together for trail walks and hikes as well as dog-walks at the Dog Run. The park is also available for special holiday and theme events throughout the year. Call 203.946.8028 for information.

For more information about these specific attractions check out the Park's website here:
<http://cityofnewhaven.com/Parks/ParksInformation/edgewoodpark.asp>

For an interactive tour of East Rock Park check it out here:
<http://cityofnewhaven.com/Parks/ParksInformation/edgewoodTour.asp>



**Edgewood Park
Edgewood Ave
New Haven, Connecticut
(203) 946-8028**

Beaver Hills *Parks continued*

Including Edgewood

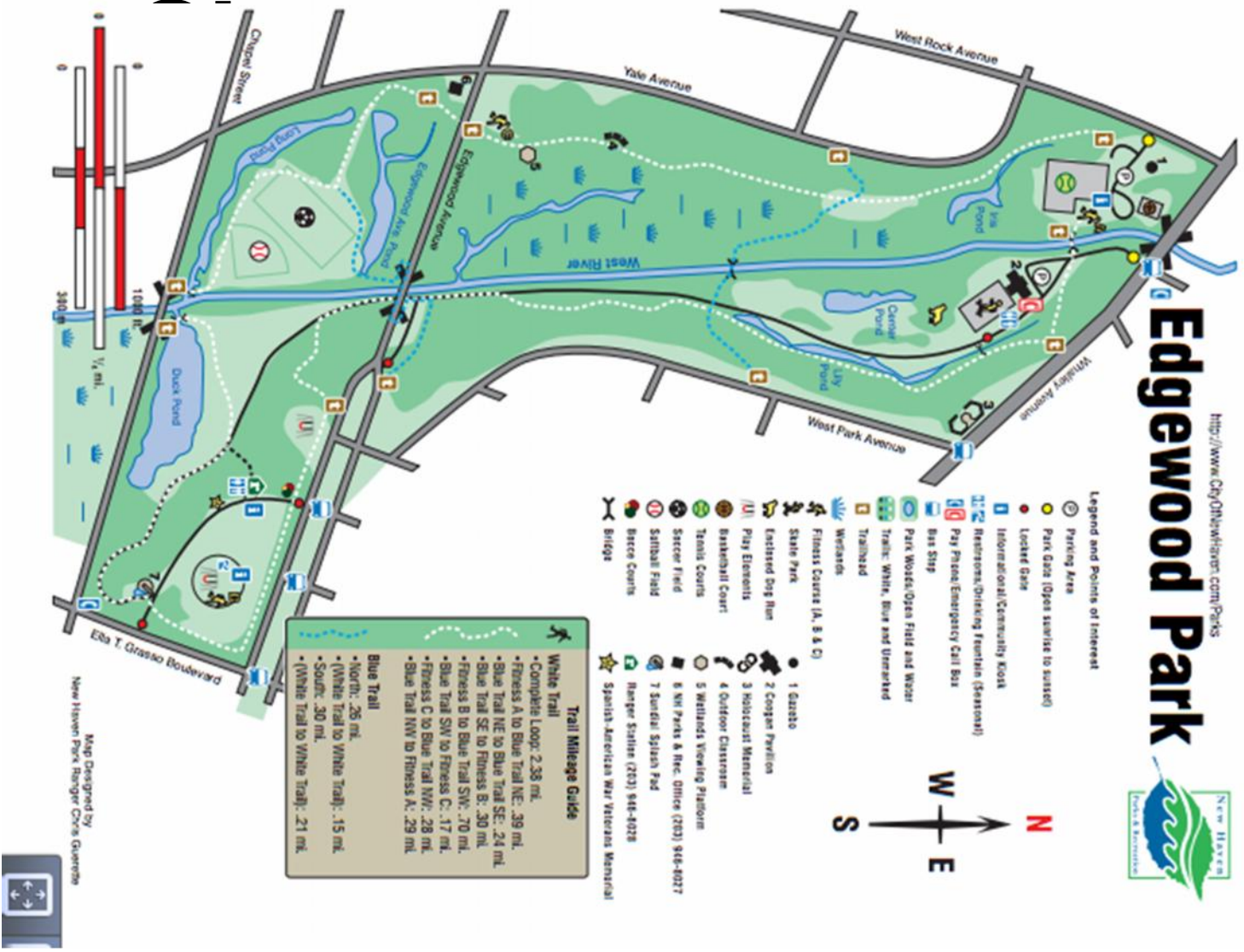

Edgewood Park Map
For more information:

<http://cityofnewhaven.com/Parks/ParksInformation/media/2008Edgewoo>

Beaver Hills *Phone Numbers to Know*

Including Edgewood

Ward 28-D Alder
Claudette Robinson
(203) 605-0293

Ward 29-D Alder
Brian Wingate
(203) 401-9457

Ward 24-D Alder
Evette Hamilton
(203) 508-5426

District Manager
Sgt. Max Joyner
(203) 946-7065

Neighborhood Specialist
Nick Licata
(203) 946-5072
(203) 410-5072

**Emergency Operations/Storm
Center**
(203) 946-8221

Management Team Chair
Evelyn Streater-Frizzle
(203) 530-9643

Beaver Hill Police Substation
(203) 946-7065

**Southern Connecticut Gas
Company**
1-800-513-8898

United Illuminating Company
(203) 499-3333

Regional Water Authority
(203) 624-6671

Animal Control
(203) 946-8110

Health Department
(203) 946-8174